

PXA140 Exploded View

PX A140 BILL OF MATERIALS			
Item	Part	Description	Qty
1	1125-TE-0018	Pump Body	1
2	2127-EP-0026	Head, Right	1
3	2127-EP-0027	Head, Left	1
4	14300-MP-0023	Bellows Assembly	2
5	5144-PF-0022	Shaft	1
6	5143-MP-0011	Shaft Seal	2
7	14200-NP-0007	Base Plate Assembly	1
8	10040-TE-0003	1/4" NPT Plug	2
9	10040-TE-0006	Plug, 5/8", .300"	4
10	4140-TE-0004	Check Plug	2
11	4135-MP-0004	Bottom Check Seat, Hi-flow	2
12	4142-MP-0003	Top Check Cage, Hi-flow	2
13	4100-MP-0003	1-1/8" Check Ball	4
14	3200-VI-0002	Diaphragm, Ø 1.190	2
15	6150-UH-0002	QEV Exhaust Seat	2
16	6150-NP-0008	QEV Muffler Cap	2
17	6140-FP-0001	QEV Baffle Porous Poly	4
18	10080-VI-023-75	O-ring, .023 X .070	2
19	6140-PP-0005	QEV Mesh, .06 & .07	6
20	10080-VI-019-75	O-ring, .019 X .070	2
21	8200-TE-0001	Proximity Cap Adapter	2
22	8110-NP-0005	Sensor Housing	2
23	8600-XX-0008	Proximity Sensor	2
24	10010-TE-0019	Jam Nut	2
25	7200-PF-0010	1" Flaretek® Body	2
26	7210-PF-0005	1" Flaretek® Nut	2
27	6090-UH-0004	QEV Body, 07	2

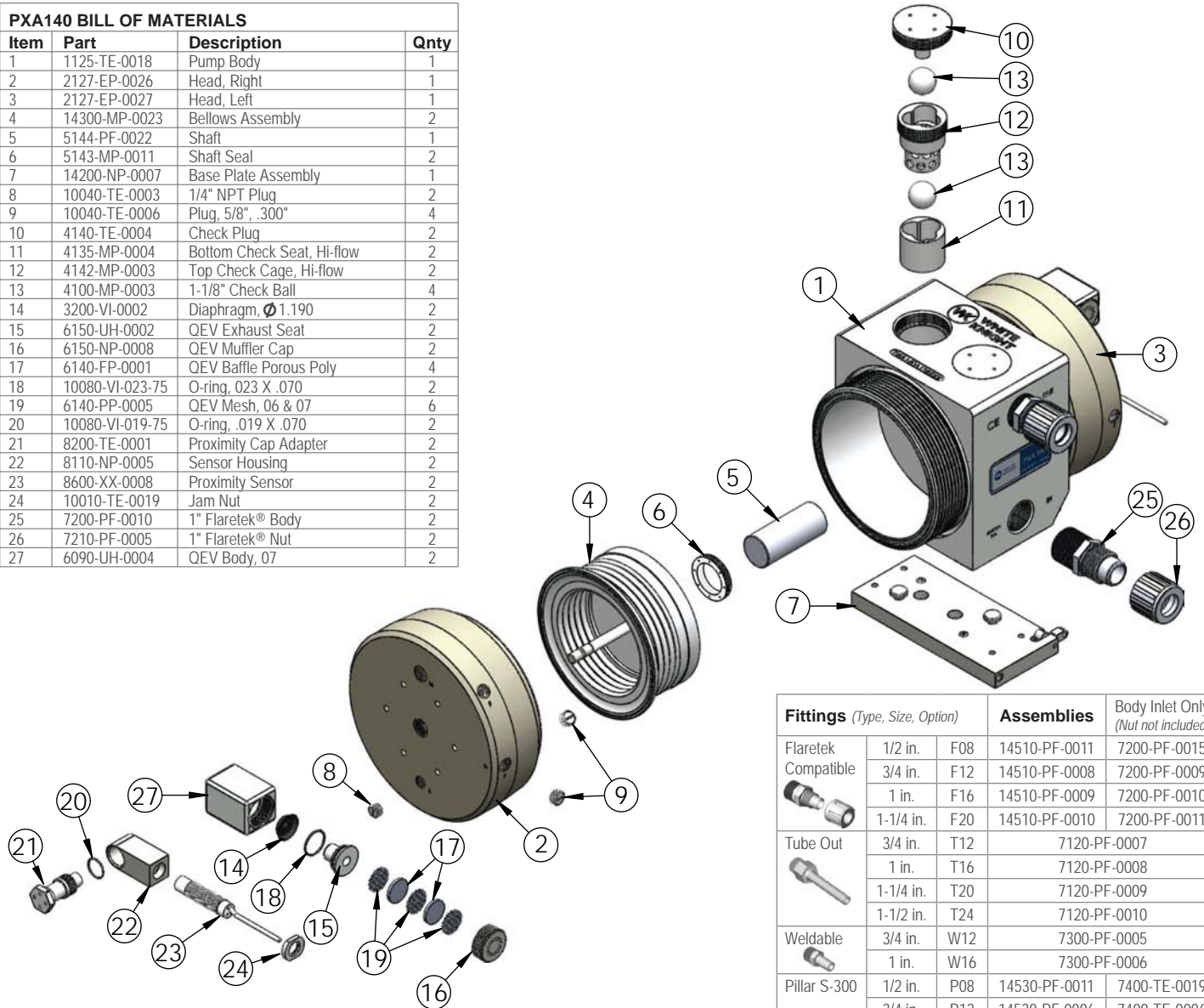

Fittings (Type, Size, Option)			Assemblies	Body Inlet Only (Nut not included)
Flaretek Compatible	1/2 in.	F08	14510-PF-0011	7200-PF-0015
	3/4 in.	F12	14510-PF-0008	7200-PF-0009
	1 in.	F16	14510-PF-0009	7200-PF-0010
	1-1/4 in.	F20	14510-PF-0010	7200-PF-0011
Tube Out	3/4 in.	T12	7120-PF-0007	
	1 in.	T16	7120-PF-0008	
	1-1/4 in.	T20	7120-PF-0009	
	1-1/2 in.	T24	7120-PF-0010	
Weldable	3/4 in.	W12	7300-PF-0005	
	1 in.	W16	7300-PF-0006	
Pillar S-300	1/2 in.	P08	14530-PF-0011	7400-TE-0019
	3/4 in.	P12	14530-PF-0006	7400-TE-0006
	1 in.	P16	14530-PF-0007	7400-TE-0007
	1-1/4 in.	P20	14530-PF-0008	7400-TE-0008
	1-1/2 in.	P24	14530-PF-0026	7400-TE-0035
FNPT	3/4 in.	N12	7100-TE-0009	
	1 in.	N16	7100-TE-0005	
	1-1/4 in.	N20	7100-TE-0010	
Synchro-Flare	1/2 in.	S08	TBD	7010-TE-0008
	3/4 in.	S12	14520-TE-0008	7010-TE-0007
	1 in.	S16	14520-TE-0007	7010-TE-0009
	3/4 in.	L12	14570-PF-0006	7800-TE-0006
PrimeLock	1 in.	L16	14570-PF-0007	7800-TE-0007
	1-1/4 in.	L20	7800-PF-0008	7800-TE-0008
Plugged		B00	7130-TE-0005	

<https://wkfluidhandling.com/pxa-series/>